

Chin Park

John F Fitzgerald Surface Rd
Boston, MA

Chin Park is the southernmost point of the Greenway. It is a linear park built above a highway. The park frequently hosts community events and celebrations. The most recent renovation in 2019 brought bright red sculptural elements, a fountain, bamboo garden, and dog park. There is also an area for children, built as a result of community input, which consists of a rubberized surface and play cubes.



LAND USE KEY	
Mixed use	Single family
Commercial	Two family
Industrial	Three family
Institutional	4-6 unit
Government	Apartment
	Condo

Site Photos

Chin Park, Boston MA



Playing Cards, Smoking, Eating, Talking
Social

Eating, Talking, Chess
Social

Walking Through
Necessary

Sitting Alone
Optional

Kids Playing
Social

Paper Lanterns



Bamboo Garden



Raising Awareness **Social**

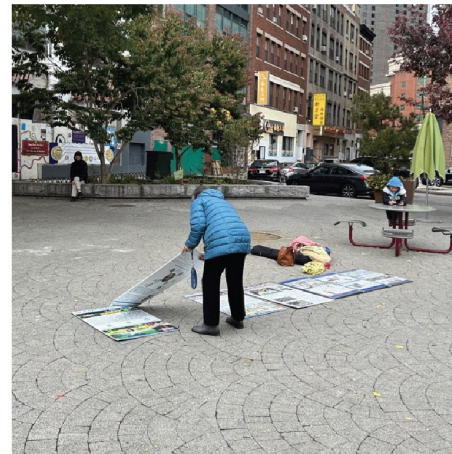

Chasing Pigeons **Social**

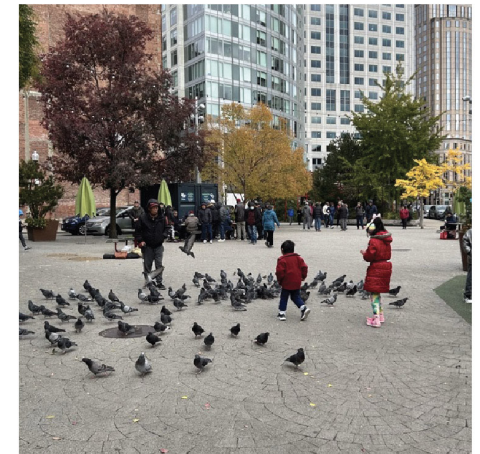

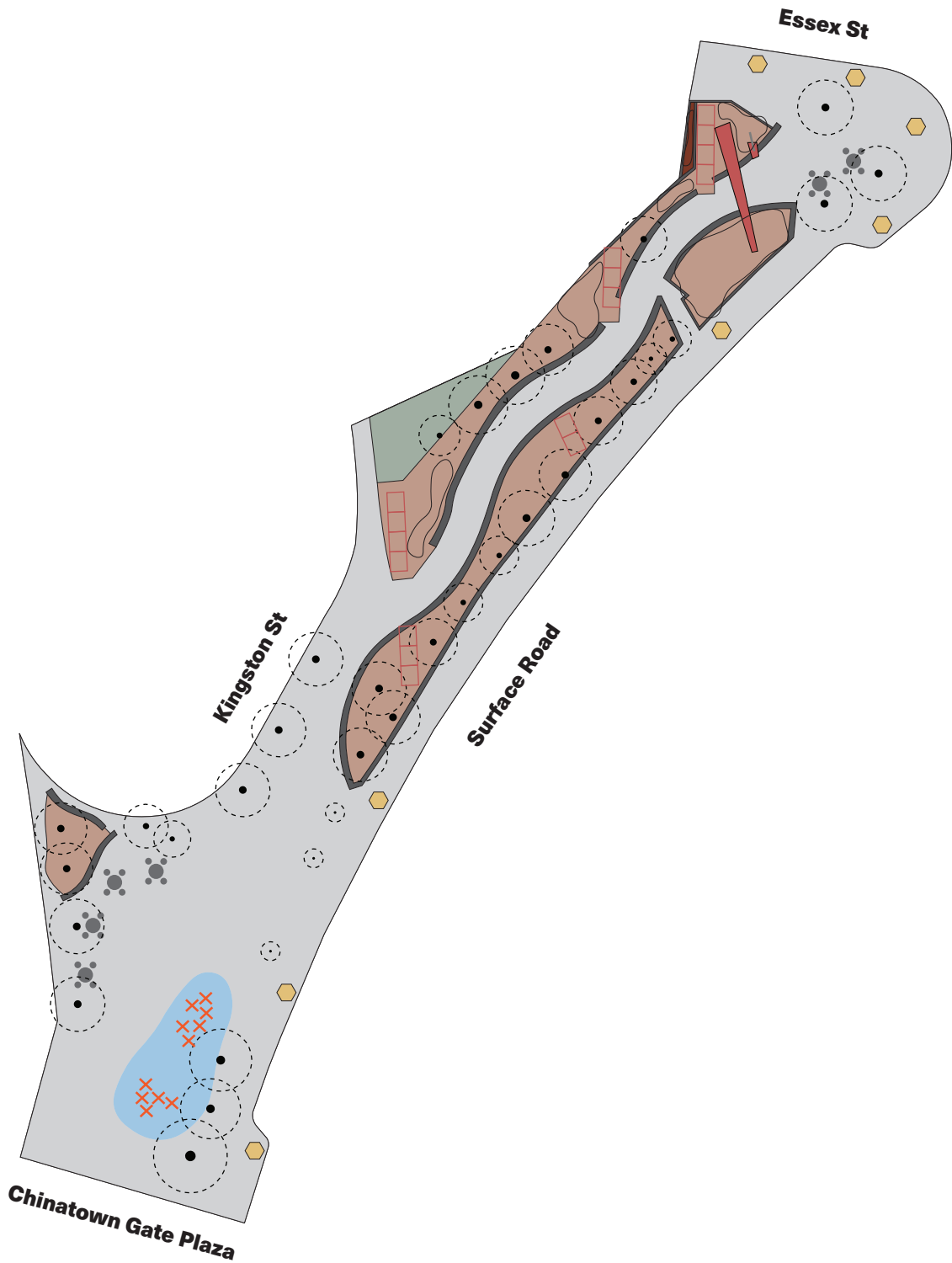

Chin Park

John F Fitzgerald Surface Rd
Boston, MA

Map Key



Stone Bench	Street Lamp
Grass	Shrubbery
Gravel	Building entrance
Rubber	Play Structure
Mulch	Seating
Tree (can be scaled)	

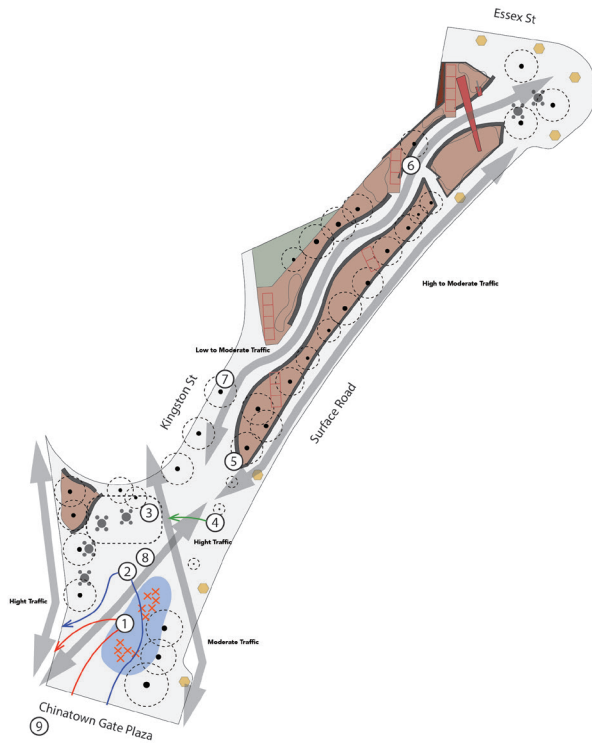

Chin Park
 John F Fitzgerald Surface Rd
 Boston, MA
 Sunday Morning 11/05
 58° Sunny

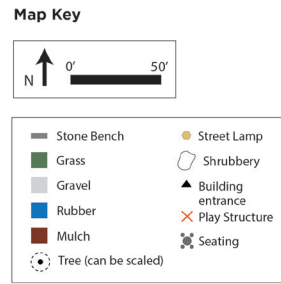

Observation Chart
 Sunday Morning 11/05

Person	Number of People	Description of person/group			Duration of time in Park	Activities
		Perceived Age	Perceived Gender	Perceived Race		
1	Group (4)	60s 70s 10s <10	3 Female 1 Male	Asian	25 mins	Children playing at playground with parents watching
2	Group (4)	60s 60s 10s <10	2 Female 2 Male	Asian	10 mins	Children chasing birds with parents watching
3	Group (20-30)	40s - 80s	Mostly M	Mostly Asian	Whole observation time	Playing cards, gambling and watching
4	Group (2)	50s 70s	2 Male	Black Latino	Whole observation time	Smoking and sitting - interacted with group 3
5	Group (2)	60s 70s	2 Male	Asian	5 mins	Sitting and talking
6	Alone	50s-60s	Male	Black	7 mins	Sitting and packing a bag
7	Alone	60s	Male	Asian	2 mins	Locking his bike and walking
8	Alone	70s	Female	Asian	Whole observation time	Laying down meditation and other chinese boards on ground
9	Group (4)	50s 10s <10 <10	2 Female 2 Male	Asian	5 mins	Three children with mother taking picture of them in front of Chinatown Gate

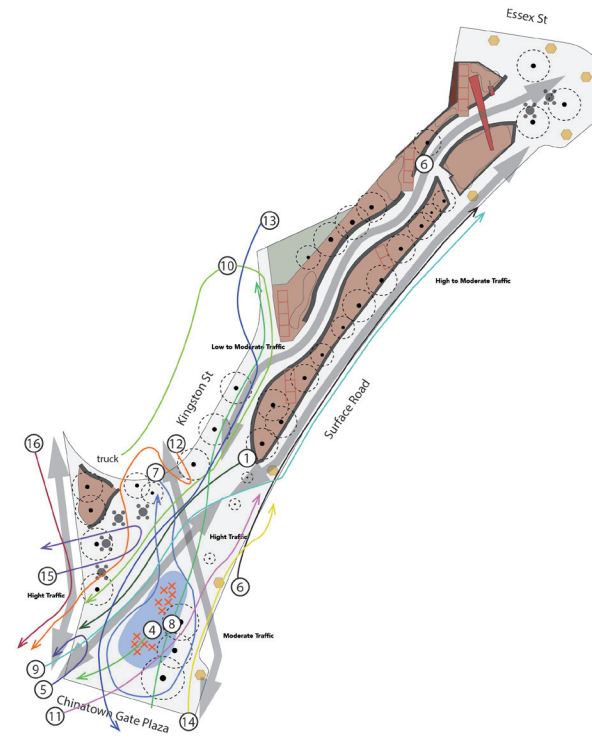

Chin Park
 John F Fitzgerald Surface Rd
 Boston, MA
 Monday Afternoon 11/06
 51° Cloudy

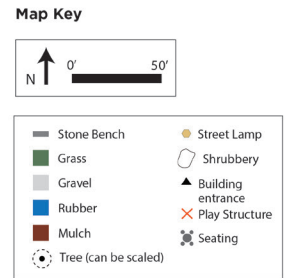

Observation Chart
 Monday Afternoon 11/06

Person	Number of People	Description of person/group			Duration of time in Park	Activities
		Perceived Age	Perceived Gender	Perceived Race		
1	Group (5)	60-70s	3 Female 3 Male	Asian	7 mins	Brought their own bench - sitting down and talking
2	Group (5)	20-30s	1 Female 4 Male	Asian	2 mins	walking through and talking
3	Group (20)	50-80s	20 Male	Asian	Whole observation time	Playing Cards
4	Group (5)	30s adults and 2 children	4 Female 1 Male	Asian	9 mins	standing + talking in play area
5	Group (2)	30s with baby	Female	Asian	3 mins	Women with stroller - stood near door and then picked up second child
6	Alone	40s	Female	Asian	2 mins	stopped at table with bag
7	Alone	40s	Male	Black	4 mins	Works at Greenway Park - Returned 10 mins later
8	Group (2)	40s teens	1 Female 1 Male	White	1 min	Playground area - stopped then walked away
9	Group (2)	40s	2 Male	Black Latino	3 mins	Walked very slowly and talked
10	Alone	40/50s	Male	Asian	16 mins	Shipping drop-off - food/drinks
11	Group (8)	50s and 5 kids	5 Female 3 Male	Asian	3 mins	kids played at playground - adults watched
12	Group (2)	40s	1 Female 1 Male	Mixed race	2 mins	Standing and Smoking walked back through 4 mins later
13	Car	40s	Male	Black/Mixed race	1min	Cop car driving through park - patrolling?
14	Group (2)	20s	2 Female	White	2mins	Walked through play area
15	Group (3)	20s	2 Female 1 Male	Asian	1min	stood and talked
16	Alone	40/50s	Male	White	5 mins	person taking photo and walking through



Chin Park

John F Fitzgerald Surface Rd
Boston, MA

Thursday Afternoon 11/09
42° Rain

Map Key

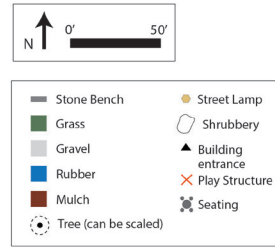

Observation Chart

Thursday Afternoon 11/09

Person	Number of People	Description of person/group			Duration of time in Park	Activities
		Perceived Age	Perceived Gender	Perceived Race		
1	Group (17)	50-70	3W 14M	Asian	Whole observation time	Playing cards, gambling, eating, smoking
2	Alone	30-40	Male	White	Whole observation time	Greenway Maintenance
3	Alone	60	Male	White	Whole observation time	Sitting on a bench
4	Group (2)	40-50	Male	Black/Hispanic	20 mins	Smoking, sitting at the tables
5	Alone	60-70	Male	Asian	10 mins	Crime Watch, walking around
6	Alone	60s	Female	Asian	2 mins	Strolling through the play area
7	Alone	40s	Male	Asian	2 mins	Smoking, strolling

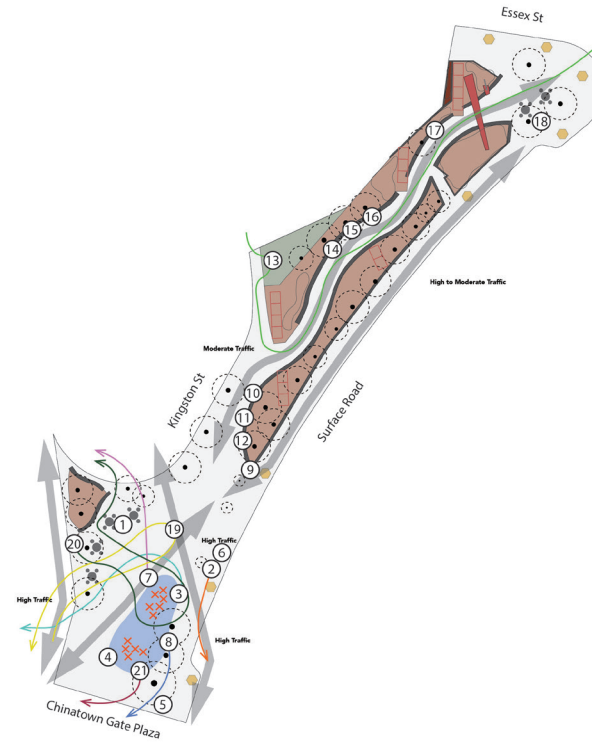

Chin Park

John F Fitzgerald Surface Rd
Boston, MA

Saturday Afternoon 11/11
45° Sunny

Map Key

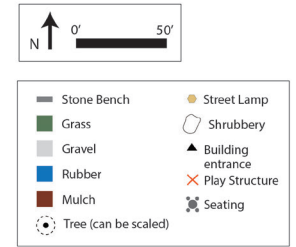

Observation Chart

Saturday Afternoon 11/11

Person	Number of People	Description of person/group			Duration of time in Park	Activities
		Perceived Age	Perceived Gender	Perceived Race		
1	Group (17-20)	70s-80s	Male	Asian	Whole Observation Period	Playing cards, gambling, eating
2	Group (2)	40s	Female	White	25 mins	sitting at the tables, painting the trees
3	Group (7)	4 (40s) 3 (8-10)	4 Male 3 Female	Asian	10 mins	adults watching kids climb in the playcubes
4	Group (8)	3 (30s) 5 (8-10)	4 Male 4 Female	Asian	Whole Observation Period	adults sitting on the bench watching kids climbing, going down the slide.
5	Group (3)	30s	2 Male 1 Female	White	Whole Observation Period	sitting on the ground and drawing the gate
6	Group (2)	50s	1 Male 1 Female	Asian	Whole Observation Period	sitting at the tables, drinking coffee and playing checkers
7	Group (3)	60s	2 Male 1 Female	Asian	Whole Observation Period	sitting on the playcubes talking
8	Group (3)	30s	Female	2 (Asian) 1 (White)	Whole Observation Period	sitting on the bench painting
9	Group (4)	70-80s	Male	Asian	Whole Observation Period	sitting and standing, talking and watching a video on a phone
10	Group (2)	40s	1 Male 1 Female	White	Whole Observation Period	sitting on the bench eating noodles
11	Group (3)	2 (30s) 1 (5-6)	2 Male 1 Female	Hispanic	Whole Observation Period	sitting on the bench while the kid eats a sandwich
12	Group (2)	60-70s	Male	Asian	Whole Observation Period	smoking and talking
13	Alone	40s	Male	White	2 mins	walking dog in the greenspace
14	Group (2)	20s	1 Male 1 Female	Black	Whole Observation Period	drinking boba, sitting, talking
15	Alone	60s	Male	White	Whole Observation Period	sitting
16	Group (3)	80s	Female	Asian	Whole Observation Period	sitting and talking, with a lot of bags
17	Alone	30s	Male	White	Whole Observation Period	sitting, talking on the phone
18	Alone	30s	Male	Black	Whole Observation Period	standing with bags
19	Group (2)	30s	Female	Asian	15 mins	standing and observing the building construction
20	Group (6)	8-12	5 Female 1 Male	White	20 mins	chasing pigeons and playing on playcubes
21	Group (25)	30-40s	15 Female 10 Male	Mostly White	15 mins	art class congregating with one instructor, all holding paintings and then taking a photo with the gate.

Use Diagram

Number of Users
per hour of observation

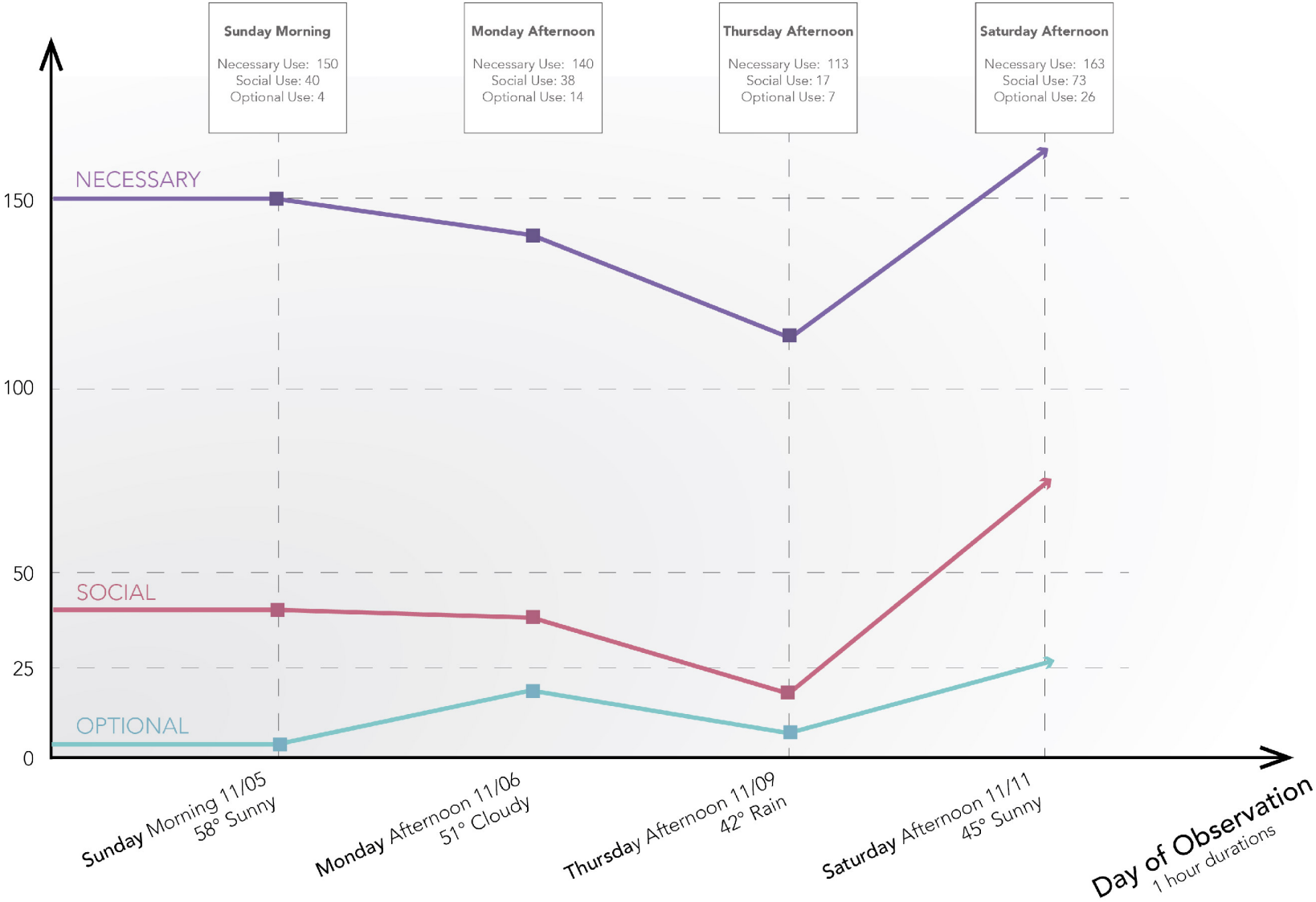

The use diagram charts the active uses of the park and outlines the change in activity within three categories: Necessary, Social, and Optional. Our analysis of this data exemplifies the high usage of the park in a necessary capacity with constant pedestrian traffic. Social and optional uses are dependent on weather and time of day. An exception is the constant social use of elderly asian men playing cards within this park (Observed on all visits). Overall usage of the park is highest during weekends with a notable jump on Saturdays.

Static vs. Dynamic Usage Diagram



Chin Park caters to both static and dynamic uses.

Static use refers to extended interaction within a defined park area, such as using seating or the play structures for socializing, eating, drinking, playing, calling, or simply relaxing.

Dynamic use involves activities like walking, running, biking, and some forms of park observation.

Static uses are social in nature while dynamic uses are necessary and optional in nature

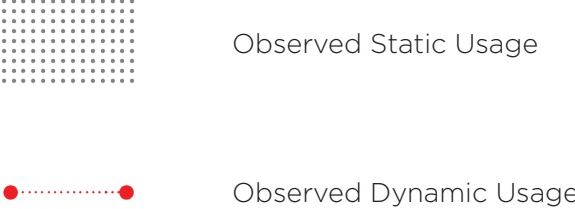

Transportation Circulation Diagram

Chin Park is positioned within a circulation quadrant structured by the transportation infrastructure. The street grid connects the park to the MBTA services and is bordered off by larger highways on the southeast corner of Chinatown. For visitors commuting to the site, the main access is provided by the green line, orange line, and the red line. Adjacent stations include Boylston, Chinatown, Downtown Crossing, Tufts Medical Center and South Station. In addition to the T, several bus stops also provide connections to Downtown and the South End. Within this quadrant pedestrian pathway circulation is outlined in red.

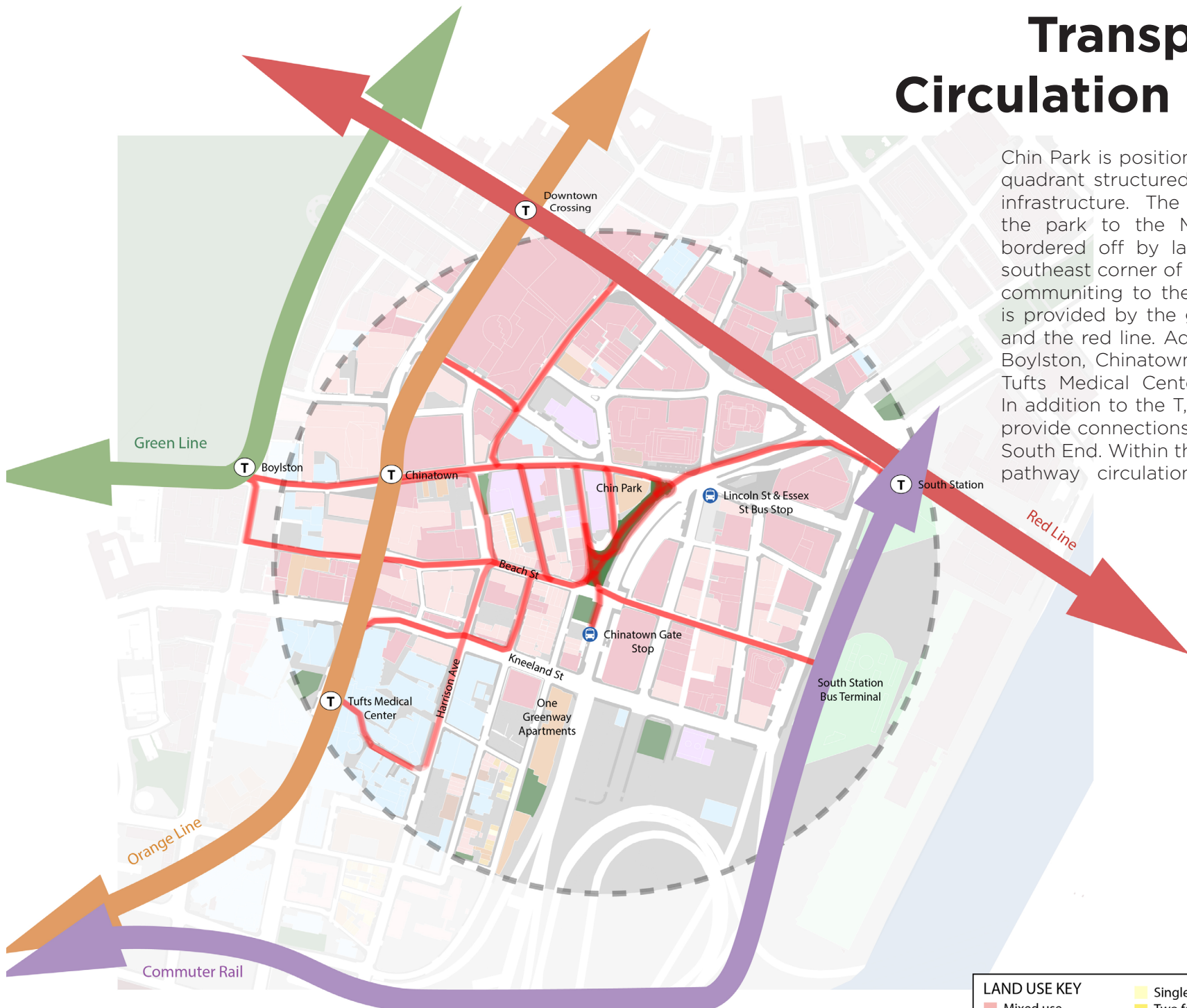

LAND USE KEY	
■ Mixed use	■ Single family
■ Commercial	■ Two family
■ Industrial	■ Three family
■ Institutional	■ 4-6 unit
■ Government	■ Apartment
	■ Condo

Perceived Gender

Chin Park, Boston MA

Demographics of **optional** and **social** users of Chin Park from four 30 minute observation periods from 11/05/23 to 11/11/23.

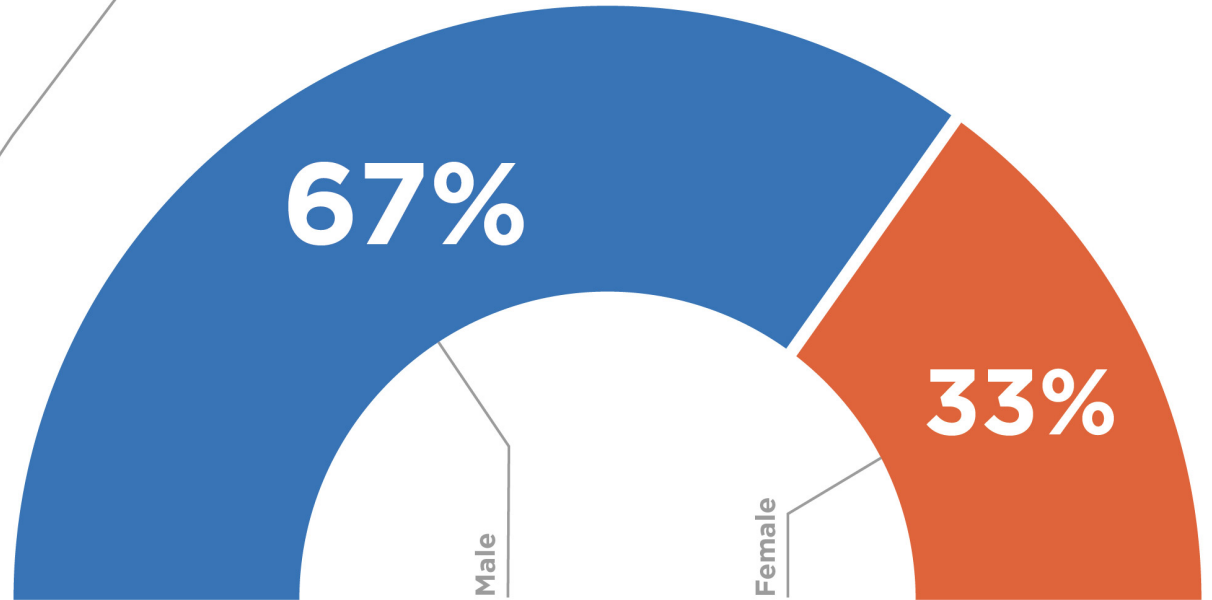
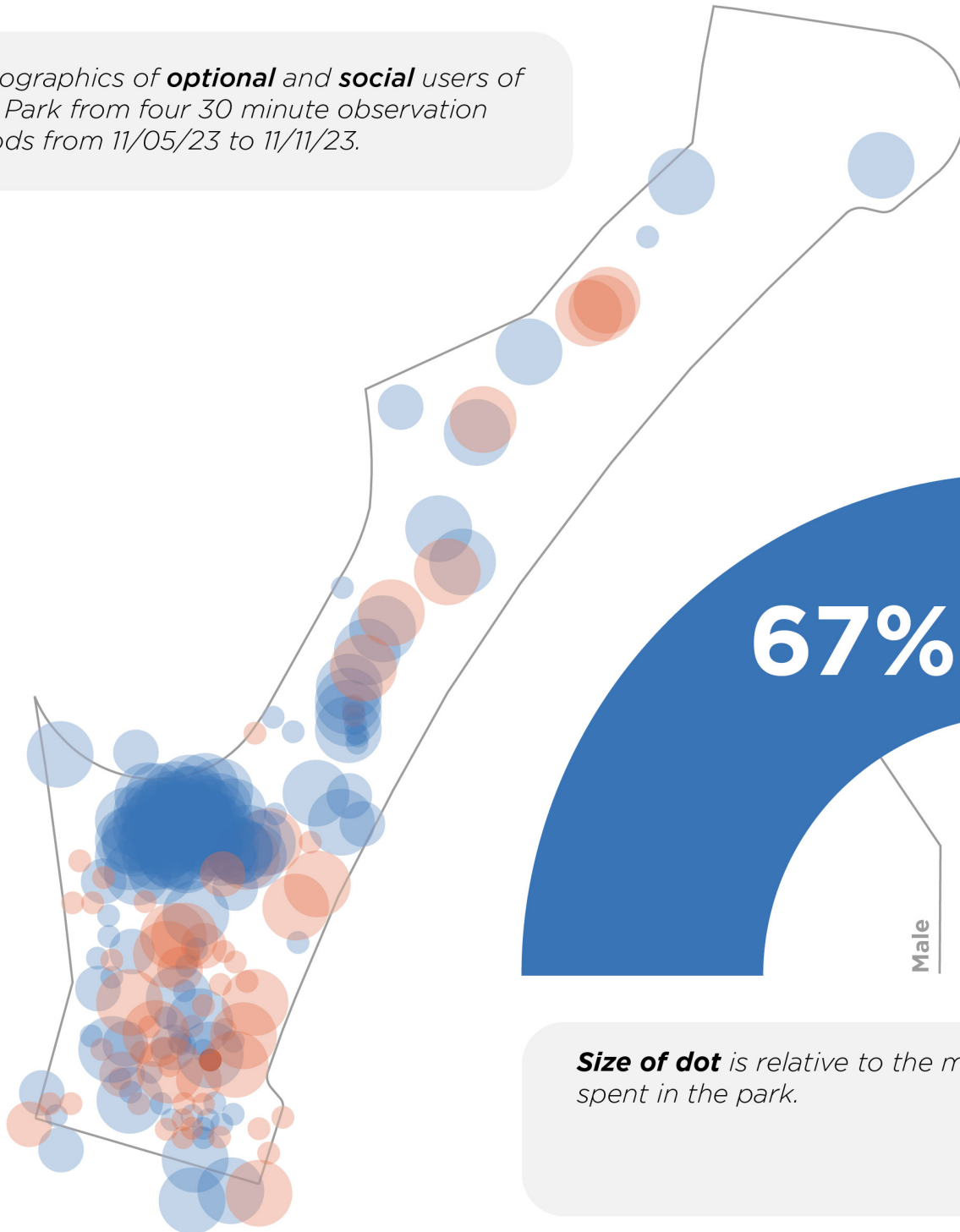

Size of dot is relative to the minutes spent in the park.



Perceived Age

Chin Park, Boston MA

Demographics of **optional** and **social** users of Chin Park from four 30 minute observation periods from 11/05/23 to 11/11/23.

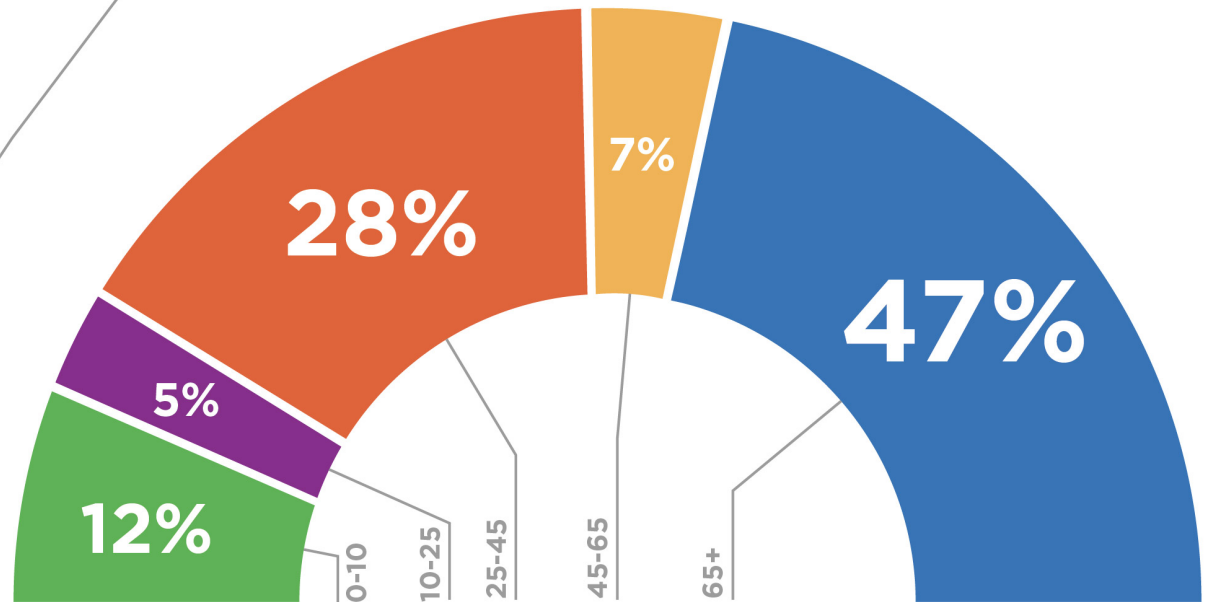
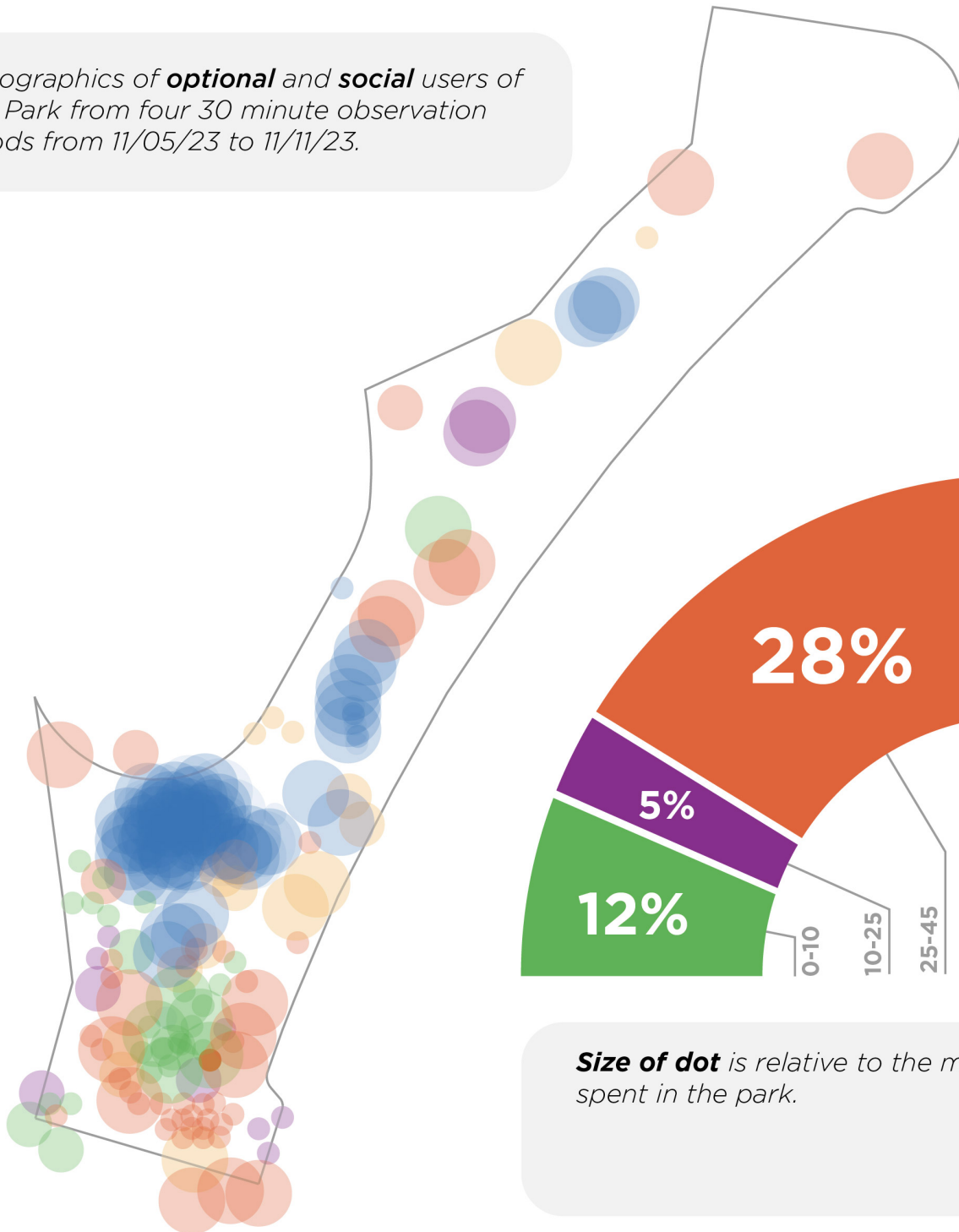

Size of dot is relative to the minutes spent in the park.



Perceived Race

Chin Park, Boston MA

Demographics of **optional** and **social** users of Chin Park from four 30 minute observation periods from 11/05/23 to 11/11/23.

