

# Eliot Norton Park

295 Tremont St.

Eliot Norton Park, a large park situated along the western edge of Chinatown, is a center of cultural connection and engagement. Children of all backgrounds come to the playground to play together, many people use the park's extensive green space and shade to sit and talk with one another, and pet owners utilize the park's ample green space to walk their dogs.

Additionally, because of its location along the borders of Chinatown, the South End, Bay Village, and Boston's downtown, Eliot Norton Park sees significant through-circulation of pedestrians using the site as part of their commute home. The park's design brings all of these uses together; the sidewalks with optimized routes for pedestrians crossing the park, a few benches and walls for people to sit, green lawns for a myriad of uses, and the playground offering an adjacent area for parents to socialize with others, while keeping an eye on their kids.



## Map Key



### Land Use:

- |               |              |
|---------------|--------------|
| Mixed Use     | Two Family   |
| Commercial    | Three Family |
| Industrial    | 4-6 Unit     |
| Institutional | Apartment    |
| Government    | Condo        |
| Single Family |              |

# Site Photos



(Source: [www.urbnparks.com](http://www.urbnparks.com))



(Source: [www.urbnparks.com](http://www.urbnparks.com))



(Source: [www.urbnparks.com](http://www.urbnparks.com))



(Source: [www.urbnparks.com](http://www.urbnparks.com))

# Eliot Norton Park

295 Tremont St.

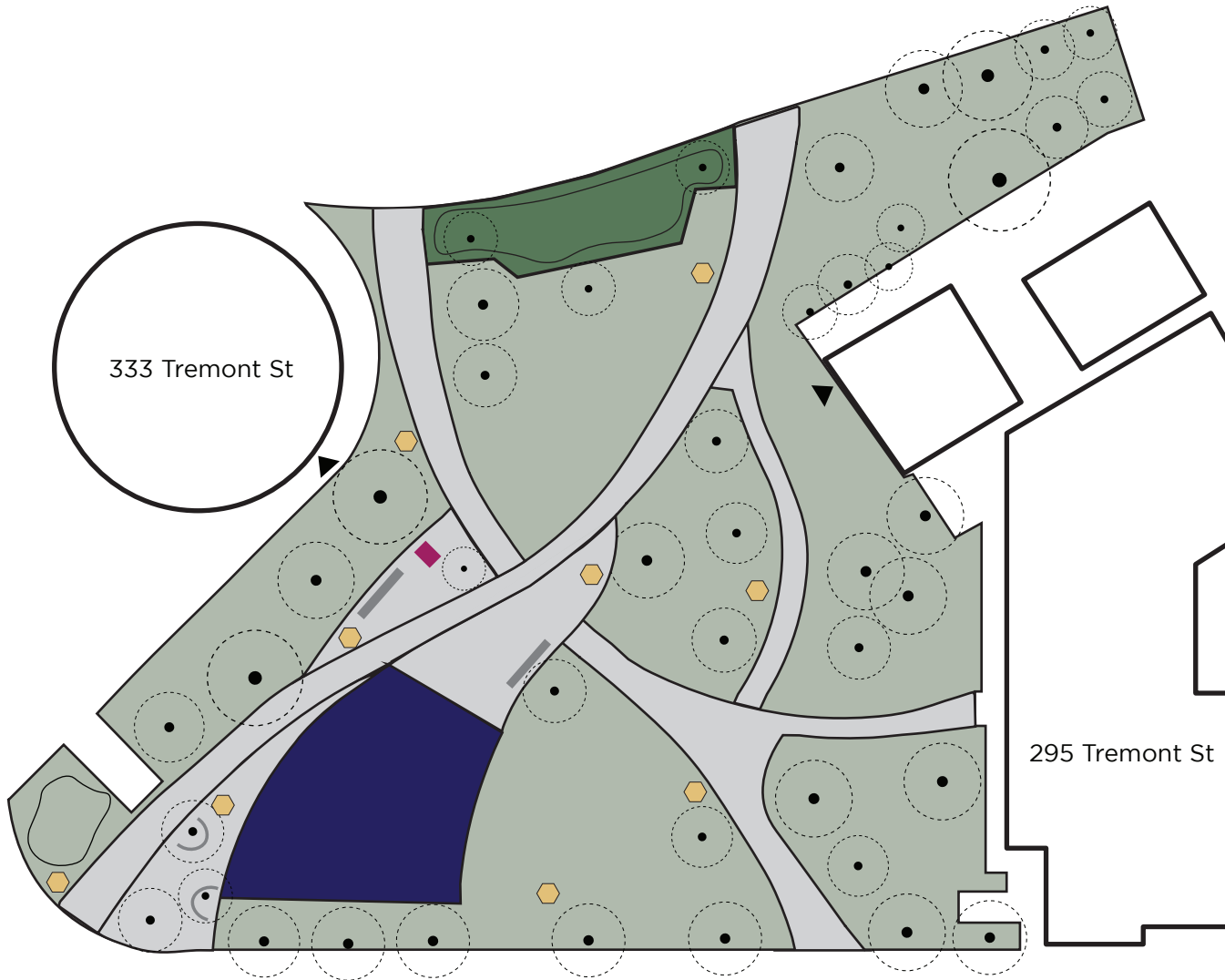

## Scale



## Map Key

Stone Bench	Street Lamp
Grass	Shrubbery
Pavement	Building entrance
Play Area	Tree
Ping Pong Table	Rain Garden

## November 5, 2023

### Site Visit

Eliot Norton Park

This site visit saw primarily three types of user groups of the park: passersby, families at the playground, and dog-walkers. Each group used the park with a unique circulation: passersby were direct and quick, playground users stayed a while and directly came and went, and dog-walkers deviated from the paths, preferring the green space.

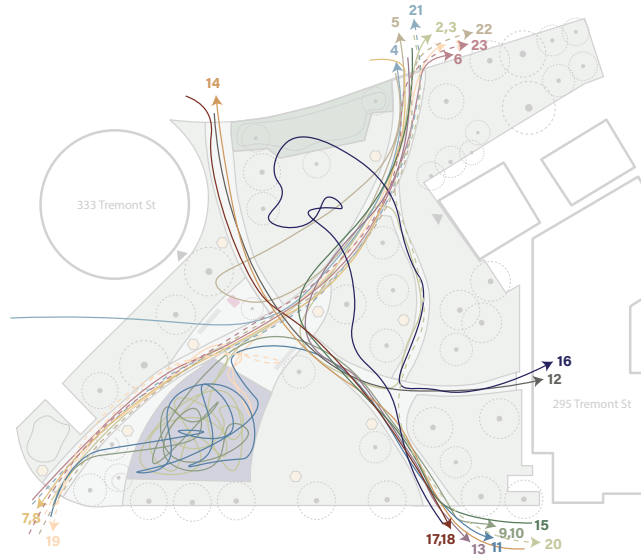

#### Scale

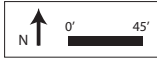

#### Map Key

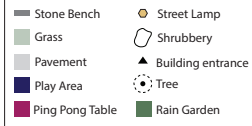

Person	Alone? Group (#)?	Description of person/group	Duration of time in Park	Activities	Date
1	Group of 3	PG: M PA: 20s-30s PR: W	30+ min	Watching children 2 and 3	11/5/23
2	Group of 3	PG: W PA: 5 PR: W	30+ min	P. riding scooter	Time: 2:45-3:30 pm
3	Group of 3	PG: M PA: 5 PR: W	30+ min	P. riding scooter	Weather: 45F, cloudy
4	Met up with man 5	PG: W PA: 20s PR: W	5 min	WP, medium-sized dog	Average Time: 7.83 min
5	Met up with woman 4	PG: M PA: 20s PR: W	5 min	WP, medium-sized dog	
6	Alone	PG: M PA: late teens-20s PR: B	< 1 min	WPT	
7	Group of 2	PG: W PA: 50s PR: A	1 min	WPT	
8	Group of 2	PG: W PA: 50s PR: A	1 min	WPT	
9	Group of 3	PG: W PA: 30s PR: W	20 min	Watching child 11	
10	Group of 3	PG: W PA: 30s PR: W	20 min	Watching child 11	
11	Group of 3	PG: M PA: 5 PR: W	20 min	P	
12	Alone	PG: W PA: 30s PR: W	< 1 min	WPT, vaped	
13	Alone	PG: W PA: 40s PR: L	< 1 min	WPT	
14	Alone	PG: M PA: 20s PR: W	< 1 min	WPT, wearing backpack	
15	Alone	PG: M PA: late 30s-40s PR: W	< 1 min	WPT, wearing backpack	
16	Alone	PG: W PA: 30s PR: W	5 min	WP, service dog, medium-sized	
17	Group of 2 with woman 18	PG: M PA: 20s PR: W	< 1 min	WPT	
18	Group of 2 with man 17	PG: W PA: 20s PR: W	< 1 min	WPT	
19	Alone	PG: M PA: late 30s-40s PR: W	3 min	Sat and ate food	
20	Alone	PG: M PA: 20s PR: W	< 1 min	Running passing through	
21	Alone	PG: M PA: late 20s-30s PR: W	< 1 min	WPT	
22	Alone	PG: M PA: 60s PR: L	< 1 min	WPT	
23	Alone	PG: W PA: 20s PR: W	< 1 min	WPT	

Key	
WPT	Walking Pass Through
WA	Walking Alone
WT	Walking Together
WG	Walking Group
SA	Sitting Alone
SG	Sitting Together
M	Man/Boy
W	Woman/Girl
A	Asian
W	White
B	Black

## November 6, 2023

### Site Visit

Eliot Norton Park

On November 6, the majority of the park's visitors were passing through. This is most likely due to the fact that it was quite cold. Two of the twenty-one visitors recorded, sat alone or at the playground briefly.

The map on the left reflects this data. The several paths within the park were used as "cut throughs" in order to reach a different destination. The paths most commonly used were in the center--creating an X-shape.

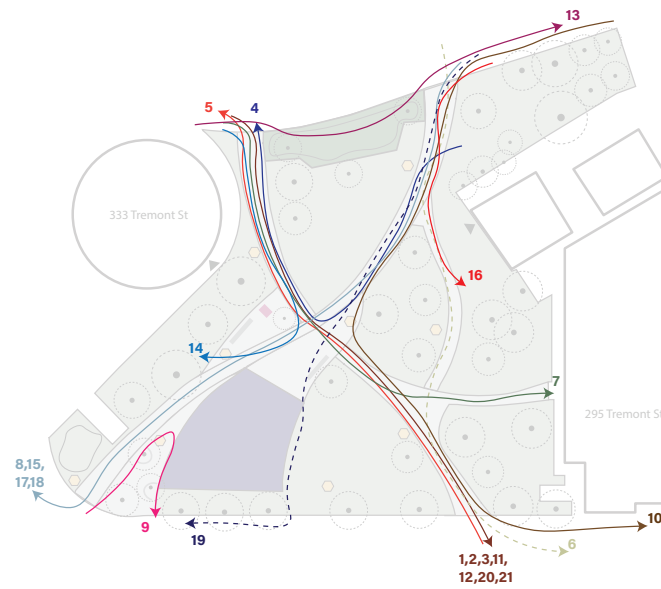

#### Scale



#### Map Key

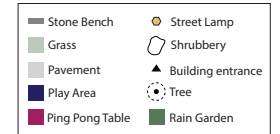

Person	Alone? Group (#)?	Description of person/group	Duration of time in Park	Activities	Date
1	Alone	PG: W PA: 30s PR: W	30 secs	WPT	11/6/23
2	Alone	PG: W PA: 30s PR: W	30 secs	WPT	Time: 4:00-5:00 pm
3	Alone	family PR: W	30 secs	WPT	Weather: 40F, Partly Cloudy
4	Alone	PG: M PA: 50s PR: W	5 min	WPT	Average Time: 1.63 min
5	Alone	PG: M PA: 30s PR: W	5 min	WPT	
6	Group	PG: W PA: 20s PR: A	1 min	WPT	
7	Alone	PG: M PA: 50s PR: W	1 min	WPT	
8	Alone	family PR: W	1 min	WPT	
9	Group	family PR: W	1 min	WPT	
10	Alone	PG: W PA: 60s PR: W	30 sec	WPT	
11	Alone	PG: M PA: 20s PR: A	-	SA	
12	Alone	PG: W PA: 30s PR: W	1 min	WPT	
13	Alone	PG: M PA: 60s PR: W	1 min	WPT	
14	Alone	PG: M PA: 60s PR: H	1 min	WPT	
15	Alone	PG: W PA: 40s PR: A	1 min	P	
16	Alone	PG: W PA: 40s PR: W	30 secs	WPT	
17	Alone	PG: W PA: 30s PR: A	30 secs	WPT	
18	Alone	PG: W PA: teen PR: H	30 secs	WPT	
19	Alone	PG: M PA: 40s PR: B	10 min	WPT	
20	Alone	PG: W PA: 50s PR: W	30 secs	WPT	
21	Alone	PG: M PA: teen PR: A	30 secs	WPT	

Key	
WPT	Walking Pass Through
WA	Walking Alone
WT	Walking Together
WG	Walking Group
SA	Sitting Alone
SG	Sitting Together
M	Man/Boy
W	Woman/Girl
A	Asian
W	White
B	Black

## November 11, 2023

### Site Visit

Eliot Norton Park

The November 11 site visit was on a sunny Saturday afternoon. However, the low temperature most likely decreased the average time spent within the park. Again, the majority of visitors were just passing through, but some stopped to sit or go to the playground. Others used the green space for dog-walking. The two central paths that form an X-shape were used the most often.



#### Scale



#### Map Key

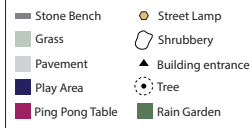

## November 15, 2023

### Site Visit

Eliot Norton Park

The November 15th site visit was a bit warmer than usual. Although the average time spent at the park was low, more people were recorded using the playground. Three separate daycare groups were recorded walking through the park or playing on the playground.

As noted previously, there is a wide range of ages that use the park, as well as a diversity of races. This is reflected in the chart on the following page.

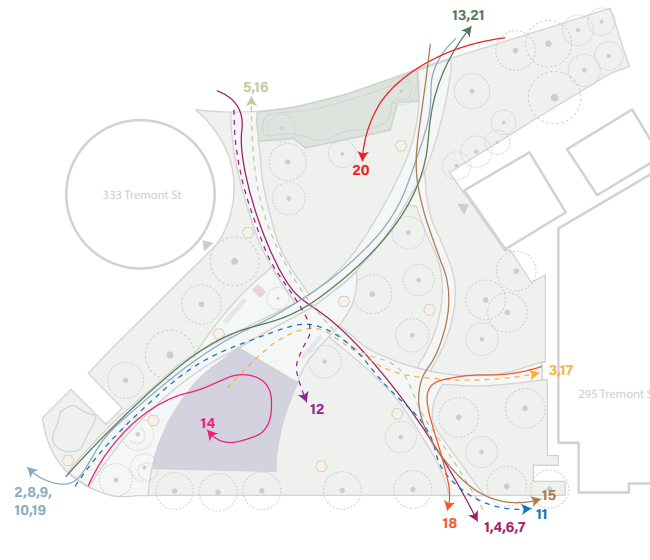

#### Scale



#### Map Key

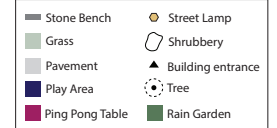

#	Alone? Group (#)?	Description of person/group	Duration of time in Park	Activities
1	Alone	PG: W PA: 20s-30s PR: A	30 secs	WPT
2	Group of 3	Family PR: W	30 secs	WPT
3	Alone	PG: W PA: 50s PR: A	15 secs	WPT
4	Alone	PG: M PA: 50s PR: B	15 secs	WPT
5	Group of 4	PG: M&W PA: 30s w kids PR: W	20 min	P
6	Group of 2	PG: W PA: 20s PR: A	15 secs	WPT
7	Alone	PG: M PA: 40s PR: W	15 secs	WPT
8	Alone	PG: W PA: 40s PR: B	15 secs	WPT
9	Alone	PG: W PA: 60s PR: W	15 secs	WPT
10	Alone	PG: M PA: 60s PR: W	2 min	WP
11	Alone	PG: M PA: teen PR: A	1 min	WPT
12	Alone	PG: M PA: 60s PR: A	30 secs	WPT
13	Alone	PG: M PA: 50s PR: W	-	TCOP
14	Alone	PG: M PA: 50s PR: B	30 secs	WPT
15	Alone	PG: W PA: 20s PR: W	15 secs	WPT
16	Group of 2	PG: W PA: 20s PR: A	5 min	S
17	Group of 3	PG: W PA: 30s PR: W	30 secs	WPT
18	Group of 3	PG: W PA: 40s PR: W	30 secs	WPT
19	Alone	PG: M PA: 30s PR: W	15 secs	WPT
20	Group of 3	PG: M&W PA: 30s PR: W	15 secs	WPT
21	Alone	PG: W PA: 60s PR: A	3 min	SA

Key	
WPT	Walking Pass Through
WA	Walking Alone
WT	Walking Together
WG	Walking Group
SA	Sitting Alone
SG	Sitting Together
M	Man/Boy
W	Woman/Girl
A	Asian
W	White
B	Black

Person	Alone? Group (#)?	Description of person/group	Duration of time in Park	Activities
1	Group of 2	PA: 60s PG: M&W PR: W	30 secs	WPT
2	Alone	PA: 20s PG: W PR: B	30 secs	WPT
3	Group	preschool diverse	-	P
4	Group	daycare diverse	3 min	WPT
5	Alone	PA: 60s PG: M PR: W	1 min	WPT
6	Alone	PA: 60s PG: W PR: A	30 secs	WPT
7	Alone	PA: 30s PG: W PR: W	30 secs	WPT
8	Group	PA: 40s PG: W&W PR: W	30 secs	WP
9	Alone	PA: 20s PG: W&M PR: H	30 secs	WPT
10	Alone	PA: 20s PG: M PR: W	30 secs	WPT
11	Alone	PA: 60s PG: W PR: A	1 min	WPT
12	Group	PA: 30s PG: W + baby PR: A	-	P
13	Alone	PA: 30s PG: W PR: B	30 secs	WPT
14	Group (20+)	daycare diverse	-	P
15	Alone	PA: 20s PG: M PR: A	30 secs	WPT
16	Alone	PA: 50s PG: M PR: W	30 secs	WPT
17	Alone	PA: 30s PG: W PR: A	1 min	entering building
18	Alone	PA: 50s PG: M PR: W	30 secs	entering building
19	Alone	PA: 20s PG: W PR: B	30 secs	WPT
20	Alone	PA: 30s PG: M PR: W	3 min	WP
21	Alone	PA: 50s PG: W PR: A	30 secs	WPT

Key	
WPT	Walking Pass Through
WA	Walking Alone
WT	Walking Together
WG	Walking Group
SA	Sitting Alone
SG	Sitting Together
M	Man/Boy
W	Woman/Girl
A	Asian
W	White
B	Black

# Circulation Diagram

Eliot Norton Park





Throughout our site visits, we found that visitors typically followed the paths made by the designers. However, specific paths were used more often than others. This diagram highlights the routes that people usually took, as well as the “off the beaten path” routes.



## Scale



## Map Key

-  **Path**
-  thick+dark = more popular route
-  thin+light = less popular route
-  **Boundary**

# Behavioral Diagram

Eliot Norton Park

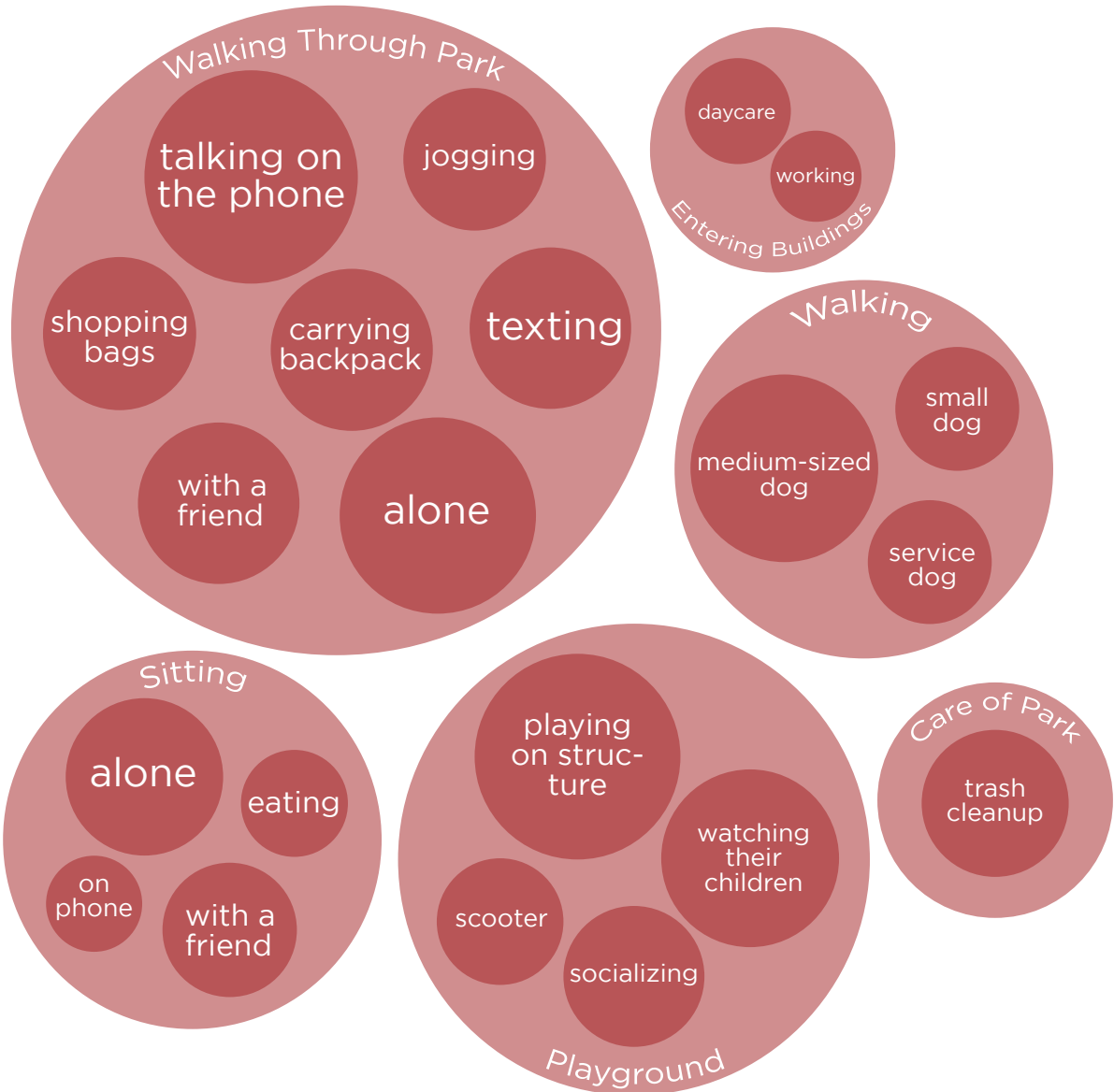

This behavioral diagram portrays the activities that visitors did throughout the park. The larger the circle, the more often that activity was recorded on our site visits. The smaller the circle, the less we saw the visitors do that activity.

It is important to note, however, that the amount of activities may increase in warmer weather. Due to the colder weather and rain, the majority of Eliot Norton Park's visitors were using it as a walking path in order to reach another destination.

### Scale



### Map Key

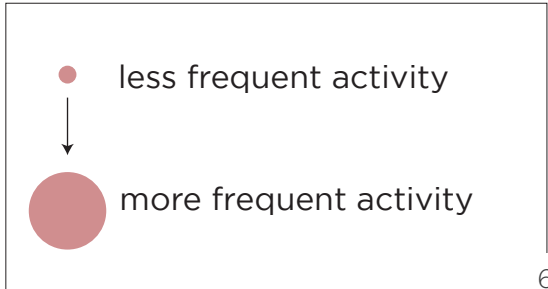

# Occupation Diagram

Eliot Norton Park

This map aggregates the data collected from the site visits to show which parts of the park are most frequently occupied. Most park visitors stay on the concrete paths or use the playground, and do not venture into the green space.

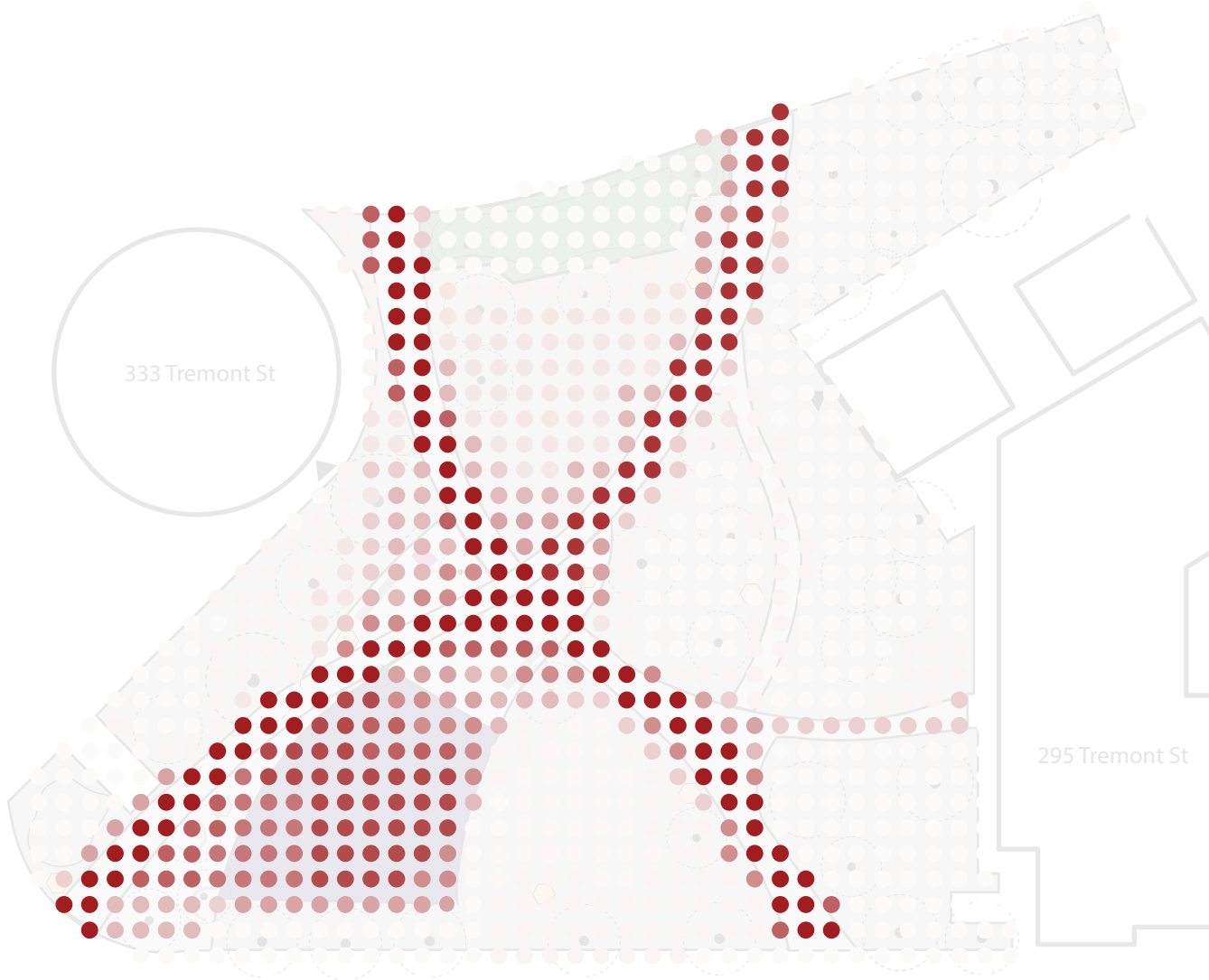

## Scale

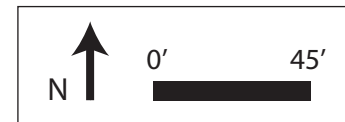

## Map Key

- rarely occupied
- ↓
- moderately occupied
- ↓
- frequently occupied





# Node Diagram

Eliot Norton Park

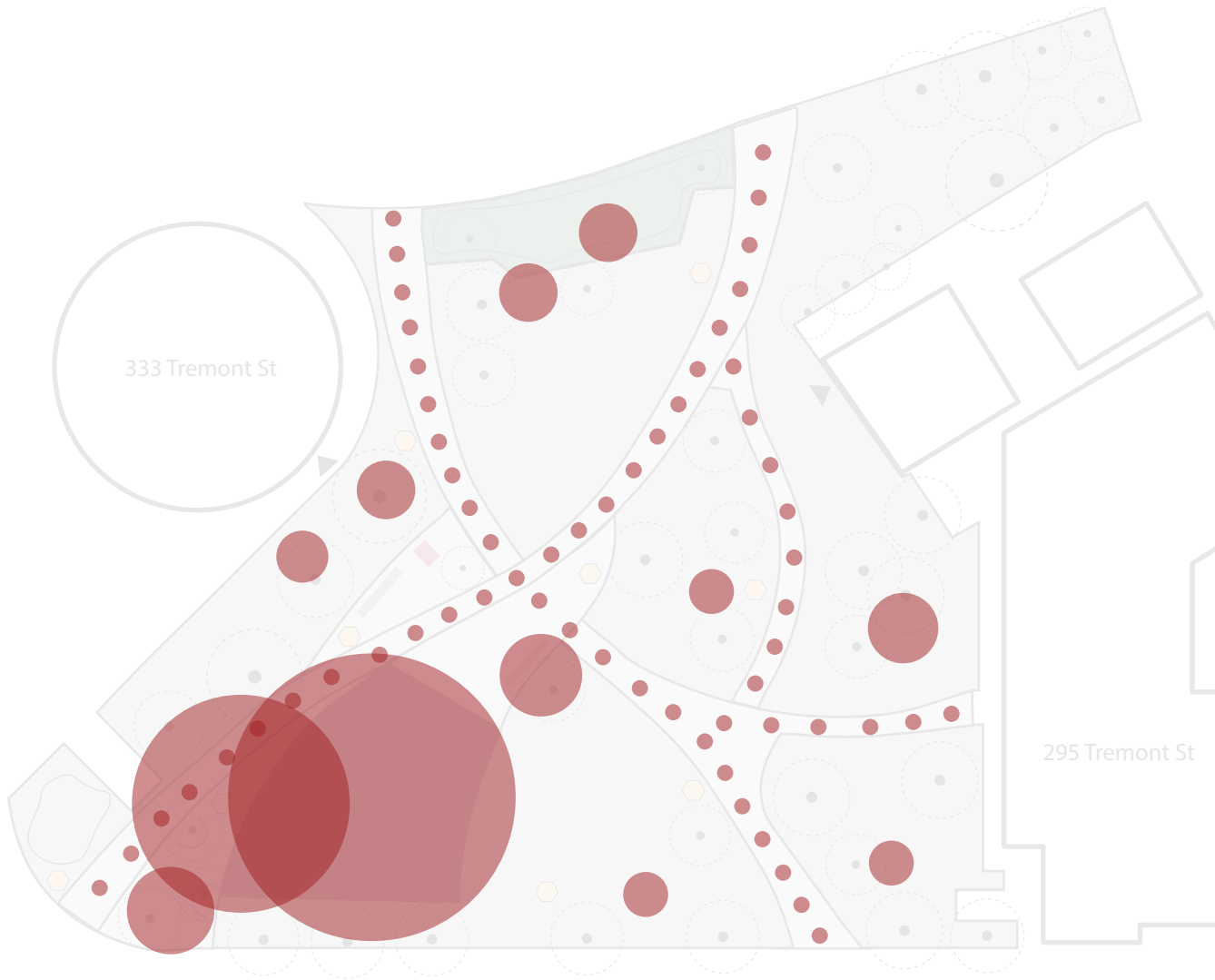

This map shows which parts of the park are spatial nodes, or places where individuals or groups gravitate towards and stay at longer. The concrete paths, although most frequently traveled on, are least likely to see people stop and stay for a while, whereas the less frequently traveled green spaces often see longer stays. This is a result of passersby using the paths to quickly navigate across the site and dog-walkers using the green space less frequently, but for longer periods of time. The playground is the only space that both sees a lot of visitors and has visitors stay a long time.

## Scale



## Map Key

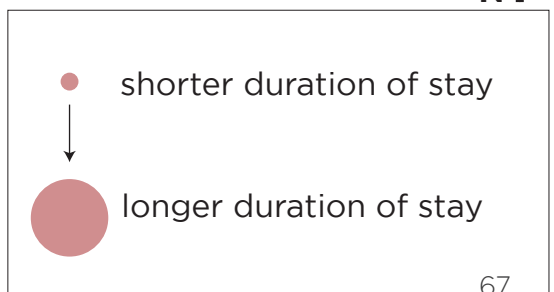

# Demographic Data

Eliot Norton Park

## RACE

Walking Through Park

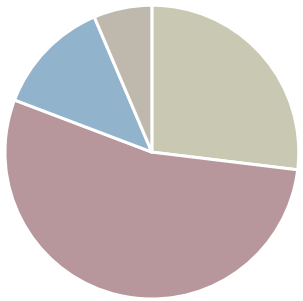

Walking Pet

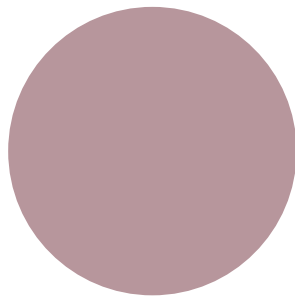

Playground

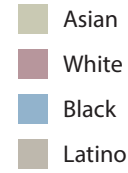
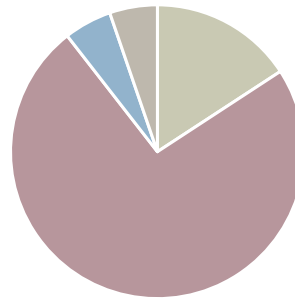

The pie charts indicate which demographic groups in what percentage use the park in the most common ways. Eliot Norton Park, being at the intersection of so many neighborhoods, is in quite a diverse area. This is reflected in the diverse “Walking Through Park” pie charts. However, activities related more with culture, such as “Walking Pet” and “Playground” are less diverse, seeing mostly or entirely white visitors. Similarly, all ages are seen in the park when walking through, but the other activities are more specific to age group.

## AGE

Walking Through Park

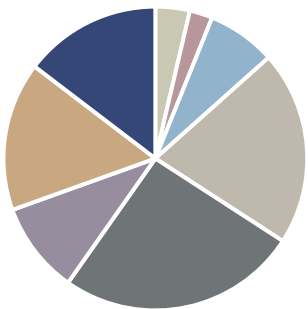

Walking Pet

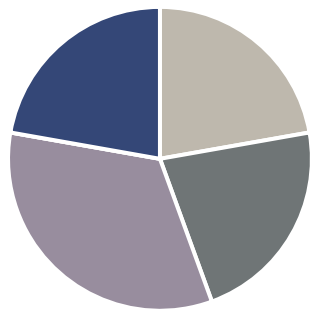

Playground

